

Technische Eigenschaften

- Gerade Rundrohre \varnothing 25 mm
- Rohrabstand 39mm
- D-Profil Sammelrohre
- Max. Betriebsdruck = 4 bar
- Prüfdruck = 6 bar
- Max. Betriebstemperatur = 110 °C

Anschlüsse und Lieferumfang

- 1 $\frac{1}{2}$ " Entlüftungsstopfen in der Verpackung enthalten
- 1 x $\frac{1}{2}$ " Blindstopfen in der Verpackung enthalten
- 4 Gewindanschlüsse
- 4 Konsolen in der Verpackung enthalten

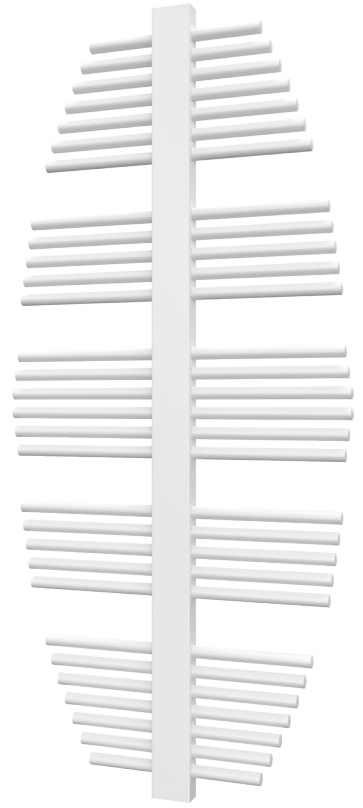

Artikelnr	Bauhöhe H (mm)	Länge L (mm)	Nab. l_1 (mm)	Breite (mm)	Rohren (n)	Wärmeleistung		Exp. (n)	Gewicht (kg)	Wasserinhalt (l)
						Δt 50°C (W)	Δt 30°C (W)			
OSWSVE0A4157000	1556	700	50	50	30	834	426	1,32	21,0	10,0
OSWSVE1A4157000	1556	700	50	50	30	584	295	1,33	21,0	10,0

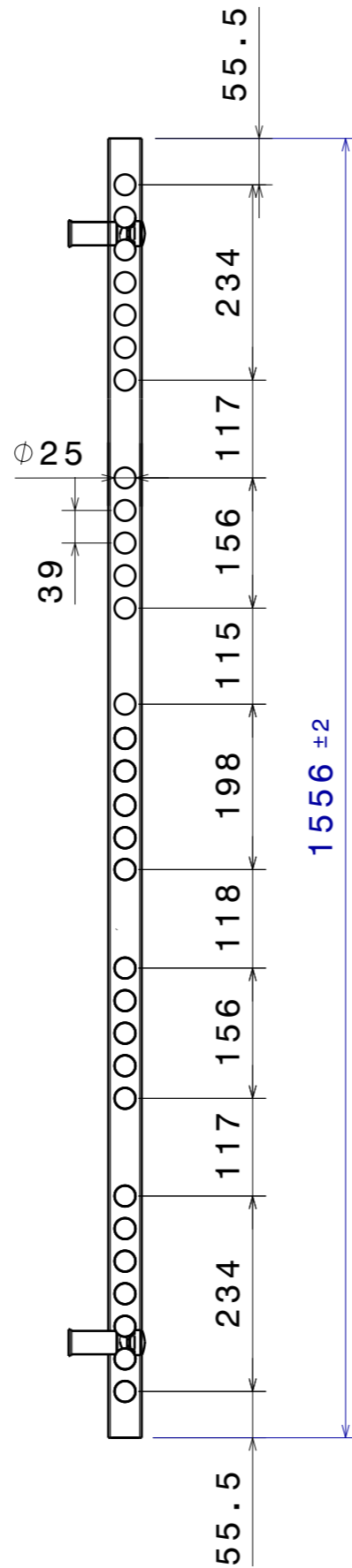
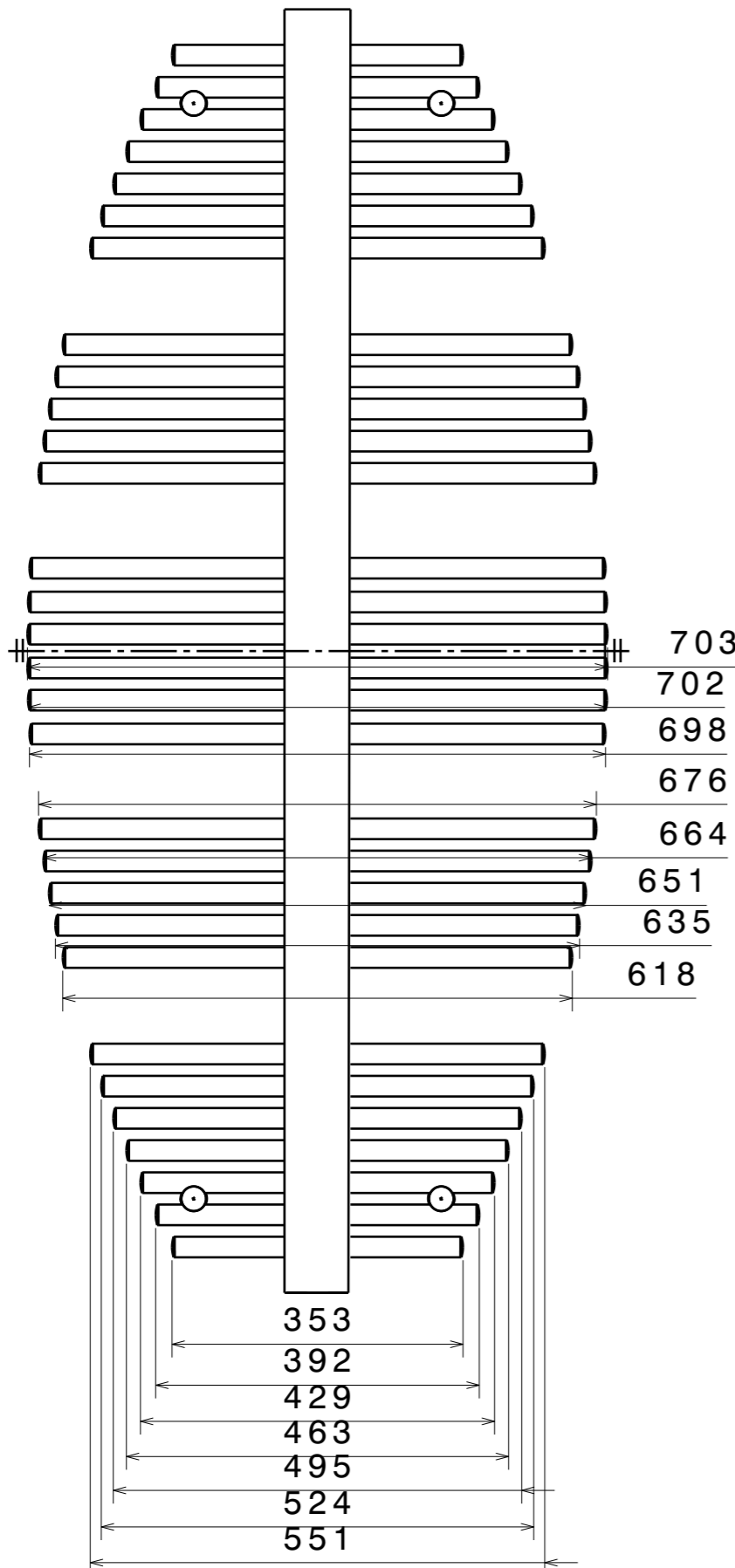
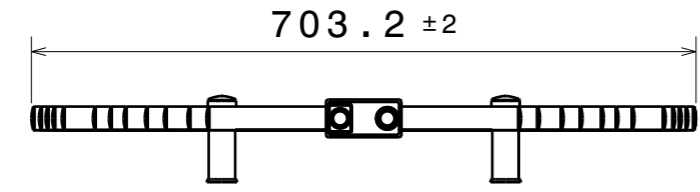

DL RADIATORS		DL RADIATORS S.p.A. SI RISERVA, A TERMINE DI LEGGE, LA PROPRIETA' DEL PRESENTE DISEGNO CON DIVIETO DI RIPRODURLO O COMUNICARLO SENZA LA SUA AUTORIZZAZIONE. ALL RIGHTS RESERVED. UNAUTHORIZED COPYING OF ALL OR PART OF THE MATERIAL IN THIS DRAWING/SPECIFICATION IS PROHIBITED			COMPONENTI CONFORMI ALLA DIR. EUROPEA 2011/65/EU (RoHS 2), REG. (CE) N.1907/2006 (REACH) E SUCCESSIVI EMENDAMENTI. ESENTI DA FORMALDEIDE, CADMIO E AMIANTO MATERIALS IN COMPLIANCE TO DIR.2011/65/EU (RoHS 2), REG.(CE) N.1907/2006 (REACH) AND FOLLOWING AMENDMENTS. NOT ALLOWED FORMALDEHYDE, CADMIUM AND ASBESTOS			
TOLLERANZE TOLERANCES ISO2768 -m		
SOSTITUISCE-REPLACE:		
DATA-DATE:		
PESO-WEIGHT-KG		
SVILUPPO-UNFOLD		
MATERIALE-MATERIAL		REV.	DESCRIZIONE MODIFICHE - REVISION DESCRIPTION			COMPILATO DRAWN	CONTROLLATO CHECKED	DATA DATE
SPECIFICA-SPECIFICATION		DENOMINAZIONE- TITLE VESPUCCI DOPPIO (1556X700) WHITE AC				CODICE - PART NUMBER OSWSVE0A4157000		REV.
SPECIFICA DI FORNITURA- DELONGHI GENERAL SUPPLY SPEC		SF1	DISEGNATO-DRAWN GIOVANNI C.	CONTROLLATO-CHECKED C.A.	DATA- DATE 21/05/2019	SCALA-SCALE 1:8	FORMATO SIZE A3	FOGLIO SHEET .