

Winkel 90°
Elbow 90°

Innengewinde / female thread
Material 1.4408 (AISI 316) V4A

301

Rohranschlussmaß		Gewicht			
Nominal Pipe Size		Weight			
(NPS)	A	kg	Artikelnummer		
			Item No.		
1/8"	17,0	0,0220	301018T	■	
1/4"	19,0	0,0356	301014T	■	
3/8"	22,0	0,0520	301038T	■	
1/2"	24,0	0,0605	301012T	■	
3/4"	27,5	0,0845	301034T	■	
1"	33,0	0,1450	301100T	■	
1 1/4"	40,0	0,2175	301114T	■	
1 1/2"	43,0	0,2864	301112T	■	
2"	52,0	0,4804	301200T	■	
2 1/2"	63,0	0,7700	301212T	■	
3"	78,0	1,4180	301300T	■	
4"	93,0	2,6620	301400T	■	

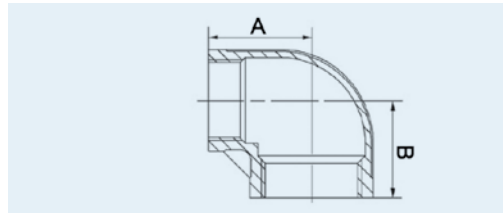

Winkel 90°
Elbow 90°

Innengewinde reduziert / female thread reduced
Material 1.4408 (AISI 316) V4A

301 R

Rohranschlussmaß			Gewicht			
Nominal Pipe Size			Weight			
(NPS)	A	B	kg	Artikelnummer		
				Item No.		
3/8" - 1/4"	22,0	19,0	0,0400	301R038014T	■	
1/2" - 3/8"	26,0	22,0	0,0620	301R012038T	■	
3/4" - 3/8"	30,0	28,0	0,0750	301R034038T	■	
3/4" - 1/2"	30,0	28,0	0,0890	301R034012T	■	
1" - 1/2"	32,0	30,0	0,1020	301R100012T	■	
1" - 3/4"	33,0	30,5	0,1205	301R100034T	■	
1 1/4" - 1"	38,5	36,0	0,1910	301R114100T	■	
1 1/2" - 1"	45,0	40,0	0,2375	301R112100T	■	
1 1/2" - 1 1/4"	43,0	40,0	0,2600	301R112114T	■	
2" - 1 1/2"	52,0	48,0	0,5100	301R200112T	■	

Alle Maße in mm / All sizes in mm
Technische Änderungen vorbehalten / Technical changes reserved

■ Standard-Lagerartikel / warehouse stock ○ Auftragsbezogene Fertigung / order related production