

Verschlußschraube
Hex head screw

Ähnlich / analog to DIN 910
zylindrisches Gewinde / with cylindric thread
ISO 228-1
Material 1.4571

331

Rohranschlussmaß	Gewicht
Nominal Pipe Size	Weight

(NPS)	L	d	kg	Artikelnummer	
				Item No.	
1/8"	17,0	14,0	0,013	331018	○
1/4"	21,0	18,0	0,024	331014	○
3/8"	21,0	22,0	0,040	331038	○
1/2"	26,0	26,0	0,069	331012	○
3/4"	30,0	32,0	0,127	331034	○
1"	32,0	39,0	0,200	331100	○
1 1/4"	33,0	49,0	0,317	331114	○
1 1/2"	33,0	55,0	0,390	331112	○
2"	40,0	72,0	0,699	331200	○
2 1/2"	50,0	75,0	1,194	331212	○
3"	55,0	95,0	1,722	331300	○

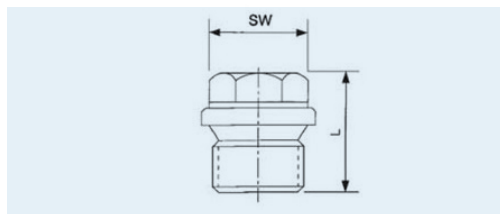

Verschlußschraube
Hex head screw

Ähnlich / analog to DIN 910
zylindrisches Gewinde / with cylindric thread
ISO 228-1
Material 1.4408 (AISI 316) V4A

33116

Rohranschlussmaß	Gewicht
Nominal Pipe Size	Weight

(NPS)	L	SW	kg	Artikelnummer	
				Item No.	
1/8"	17,0	10,0	0,0126	33116018T	■
1/4"	21,0	13,0	0,0230	33116014T	■
3/8"	21,0	17,0	0,0378	33116038T	■
1/2"	26,0	19,0	0,0676	33116012T	■
3/4"	30,0	24,0	0,1238	33116034T	■
1"	32,0	27,0	0,1932	33116100T	■
1 1/4"	33,0	30,0	0,3048	33116114T	■
1 1/2"	34,0	30,0	0,3870	33116112T	■
2"	40,0	36,0	0,6950	33116200T	■

Alle Maße in mm / All sizes in mm
Technische Änderungen vorbehalten / Technical changes reserved

■ Standard-Lagerartikel / warehouse stock ○ Auftragsbezogene Fertigung / order related production