

Verschraubung flach dichtend / (311)
Verschraubung konisch dichtend / (312)

Union flat seat / (311)
Union conical seat / (312)

Innengewinde / female thread
Material 1.4408 (AISI 316) V4A

311/312

Rohranschlussmaß	Gewicht
Nominal Pipe Size	Weight

(NPS)	L	L1	L2	SW	SW1	kg	Artikelnummer	
							Item No.	
1/8"	30,0	12,0	9,0	26,5	16,5	0,0600	31x018T	■
1/4"	30,0	12,0	9,0	26,5	16,5	0,0600	31x014T	■
3/8"	32,5	12,5	10,0	31,0	20,5	0,0700	31x038T	■
1/2"	38,0	14,0	12,0	35,0	24,0	0,0975	31x012T	■
3/4"	40,0	14,0	13,0	43,0	30,0	0,1411	31x034T	■
1"	49,0	17,0	16,0	50,0	37,0	0,2215	31x100T	■
1 1/4"	50,0	17,0	16,5	60,5	45,0	0,2895	31x114T	■
1 1/2"	56,0	19,0	18,5	67,0	52,0	0,3880	31x112T	■
2"	62,0	21,0	20,5	81,0	64,0	0,6005	31x200T	■
2 1/2"	68,0	23,0	22,5	104,5	82,5	1,0650	31x212T	■
3"	77,0	26,0	25,5	121,5	96,0	1,5500	31x300T	■
4"	83,0	30,0	26,5	150,0	126,0	2,7650	31x400T	■



Verschraubung flach / Flat union



Verschraubung konisch / Conical union

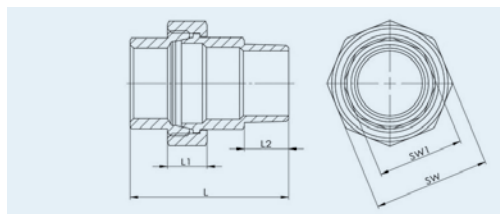

Verschraubung flach dichtend / (311A)
Verschraubung konisch dichtend / (312A)

Union flat seat / (311A)
Union conical seat / (312A)

Innengewinde / Außengewinde female- / male thread
Material 1.4408 (AISI 316) V4A

311A/312A

Rohranschlussmaß	Gewicht
Nominal Pipe Size	Weight

(NPS)	L	L1	L2	SW	SW1	kg	Artikelnummer	
							Item No.	
1/8"	42,0	12,0	12,0	26,5	16,5	0,0650	31xA018T	■
1/4"	42,0	12,0	12,0	26,5	16,5	0,0775	31xA014T	■
3/8"	45,0	12,5	12,5	31,0	20,5	0,0850	31xA038T	■
1/2"	53,0	14,0	15,0	35,0	24,0	0,1085	31xA012T	■
3/4"	57,0	14,0	17,0	43,0	30,0	0,1600	31xA034T	■
1"	68,0	17,0	19,0	50,0	37,0	0,2475	31xA100T	■
1 1/4"	71,0	17,0	21,0	60,5	45,0	0,3595	31xA114T	■
1 1/2"	79,0	19,0	23,0	67,0	52,0	0,4825	31xA112T	■
2"	88,0	21,0	26,0	81,0	64,0	0,7390	31xA200T	■
2 1/2"	98,0	23,0	30,0	104,5	82,5	1,2370	31xA212T	■
3"	108,5	26,0	31,5	121,5	96,0	1,9600	31xA300T	■
4"	123,0	30,0	40,0	150,0	126,0	3,2600	31xA400T	■



Verschraubung flach / Flat union



Verschraubung konisch / Conical union

Artikelcodierung: X steht für „1“ - flach, „2“ - konisch / Item code: X means „1“ - flat seat, „2“ - conical seat

Alle Maße in mm / All sizes in mm

Technische Änderungen vorbehalten / Technical changes reserved

■ Standard-Lagerartikel / warehouse stock ○ Auftragsbezogene Fertigung / order related production